

Transformer Core Welding Machine

IWT

Industrielle
Wickeltechnik

Core laminations from **EI 30 - EI 150N**
2 welded seams simultaneously

TKSM 1200



User-friendly panel



Swivelling type unit

TKSM

Type change in max. **2** minutes
Transformer production in cycles
of **4 - 10** seconds

Right of alterations and technical development reserved !

50 Years of Experience in Winding Techniques !



IWT

Industrielle
Wickeltechnik

**Transformer core
welding machine with
turnstile for highest
flexibility**

**Weldable transformer
core laminations from
EI 30 to EI 150N**

Wire feed-in possible

Transformer Core Welding Machine TKSM 1200

Sequence of operations

- 1.) Insert E core laminations with bobbin
- 2.) Position I-core laminations
- 3.) Swivel type unit
- 4.) Two-hand control for welding process
- 5.) During the welding process (behind guard) the sequence of operations can be continued with point 1 as soon as the welded transformer has been removed.

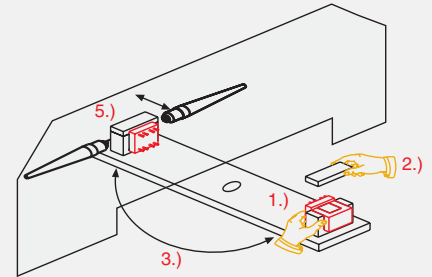

Technical data

- | | |
|----------------------------|--|
| 1.) Type range: | EI 30 - EI 150N |
| 2.) Control console: | Lauer |
| 3.) Controller: | Siemens |
| 4.) Pneumatics: | Festo |
| 5.) Inert gas supply: | Braided hose, external 15 mm, internal 9mm, Argon or Argon with 5 % hydrogen |
| 6.) Compressed air supply: | Braided hose external 15 mm, internal 9mm, min. working pressure 5 bar air consumption 3,8 l/cycle |
| 7.) Power sources: | gas-cooled, torch SR 26 |
| 8.) Electrical supply: | CEE connector 32A
3 x 400V AC/50 Hz
Power supply 8 kVA,
Back-up fuse 25 A |
| 9.) Weight: | approx. 550 kg
(incl. power sources) |

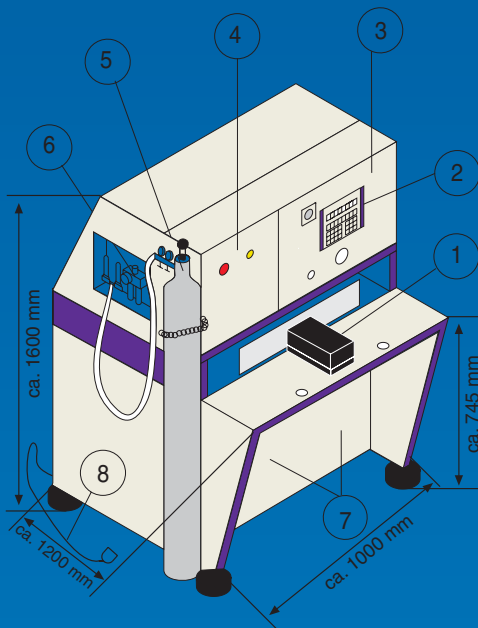

IWT

Industrielle Wickeltechnik GmbH
Weinstraße 39

D-91058 Erlangen (Germany)

Tel.: +49 (0) 9131 698 275

Fax: +49 (0) 9131 698 210

E-mail: info@iwt-gmbh.de

Internet: www.iwt-gmbh.de